

DETALLE DESARENADOR

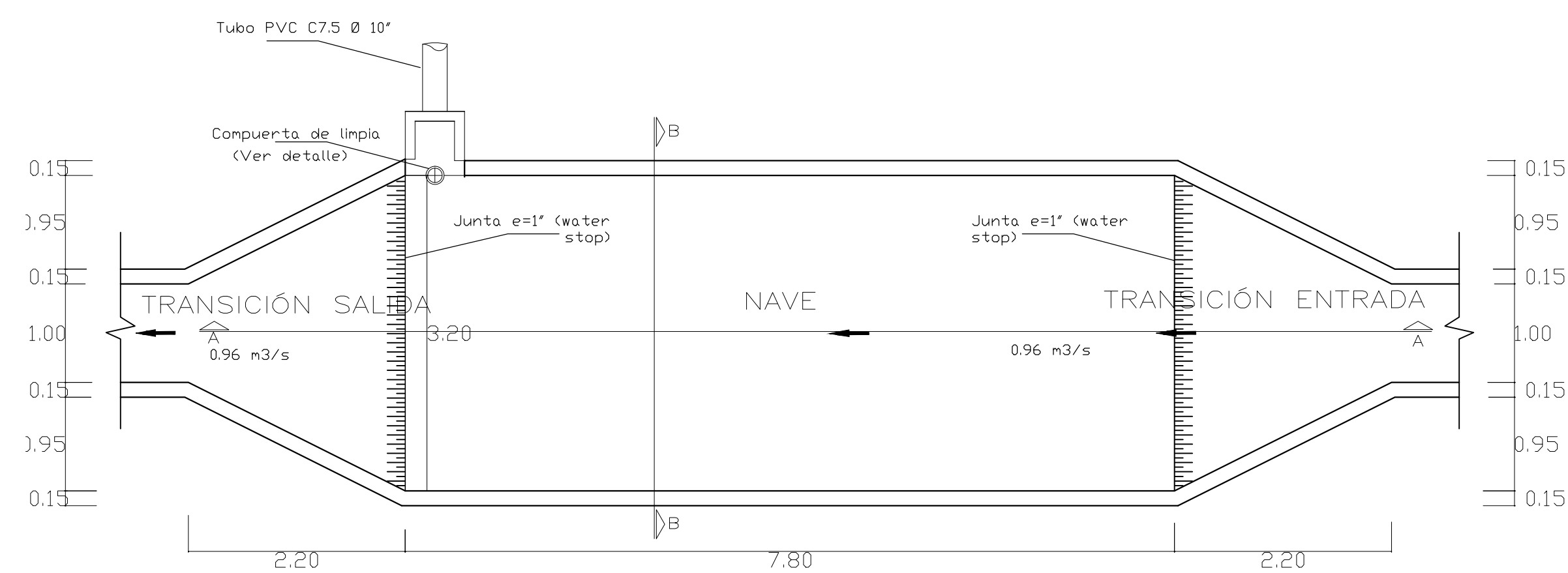

PLANO DE PLANTA
Esc. 1/50

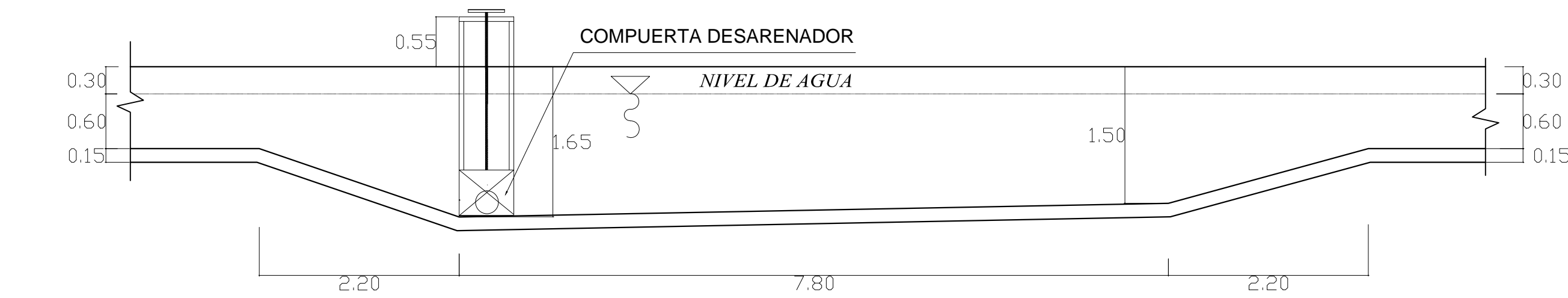

CORTE A-A
Esc. 1/50

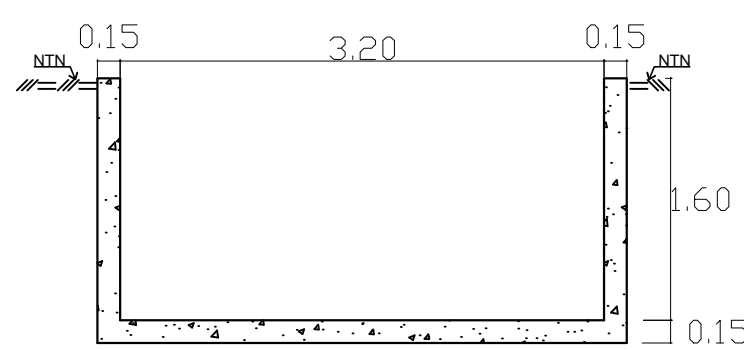

CORTE B-B
Esc. 1/25

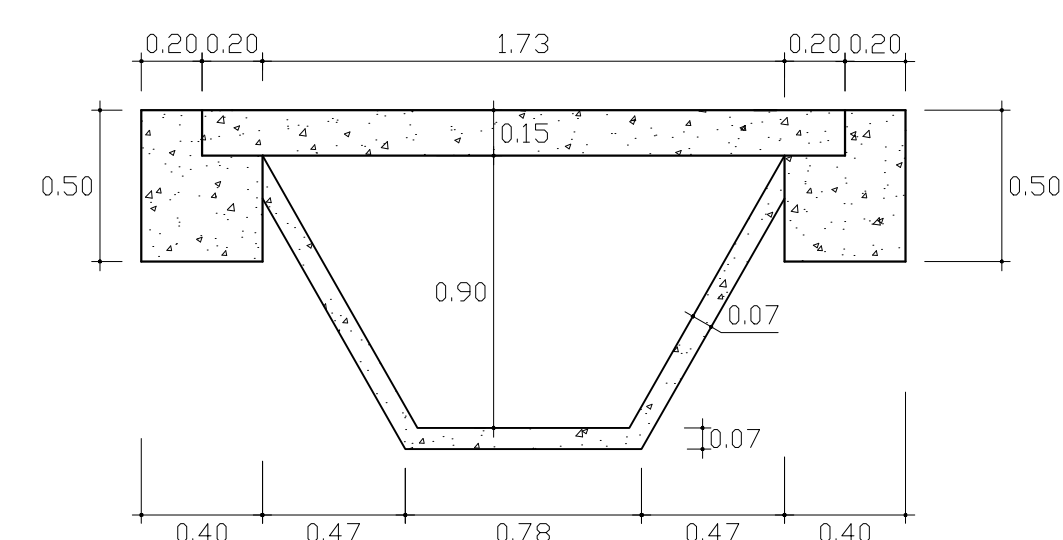

PASE PEATONAL CANAL
Esc. 1/25

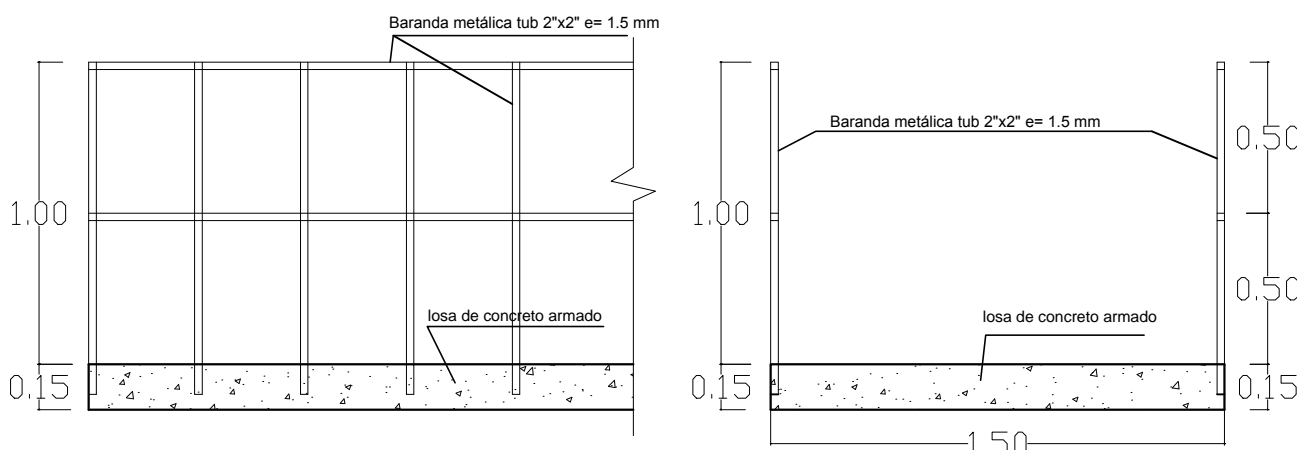

BARANDA LOSA DE PASE PEATONAL
Esc. 1/25

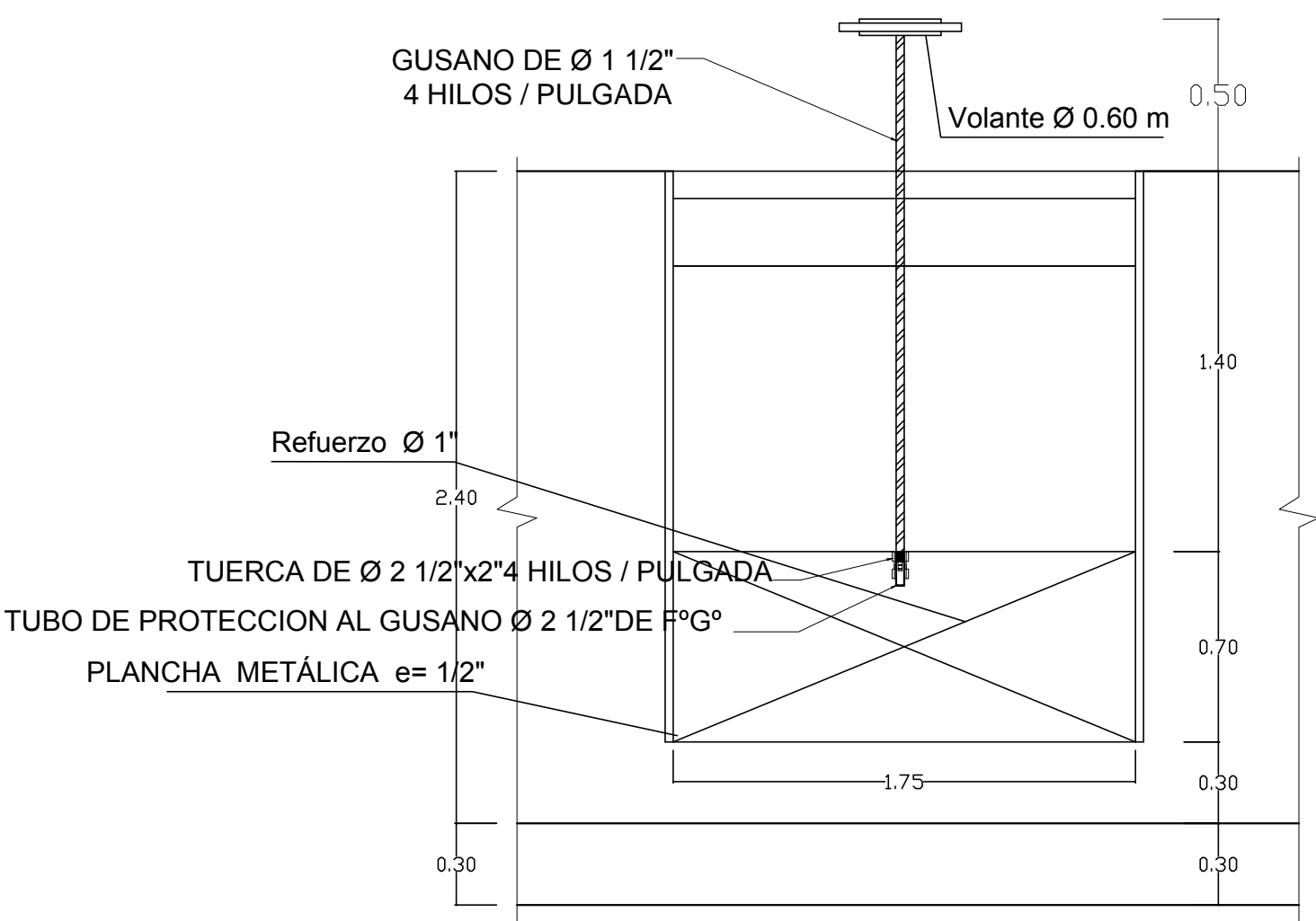

COMPUERTA C2
Esc. 1/25

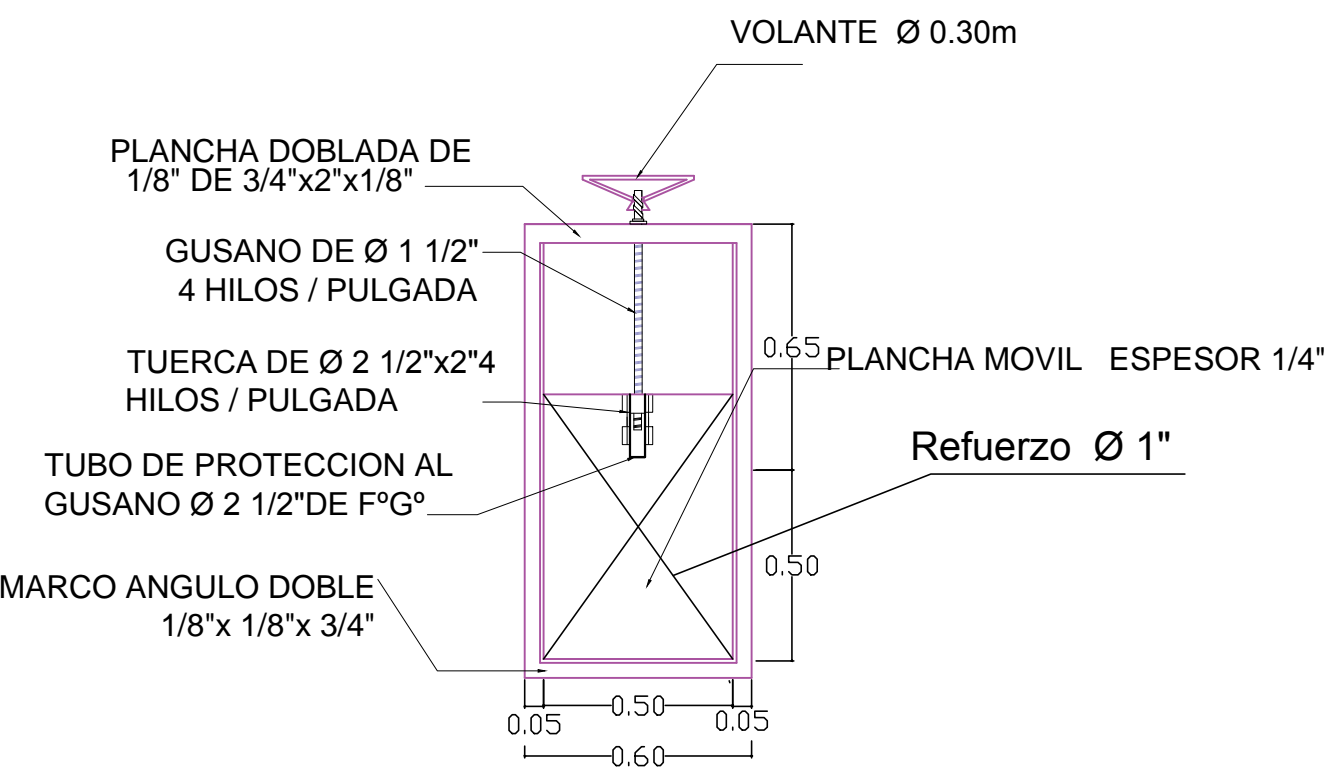

DETALLE DE COMPUERTA
CANAL
Esc. 1/20

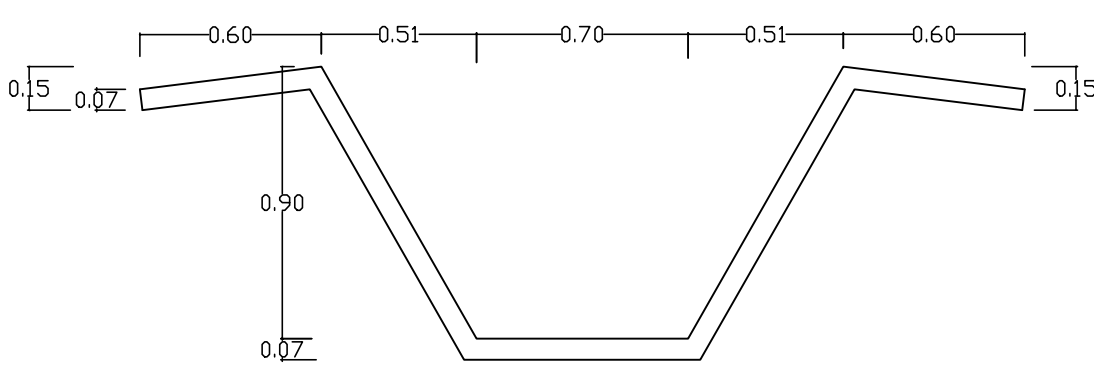

CANAL TRAMO 1
Esc. 1/25

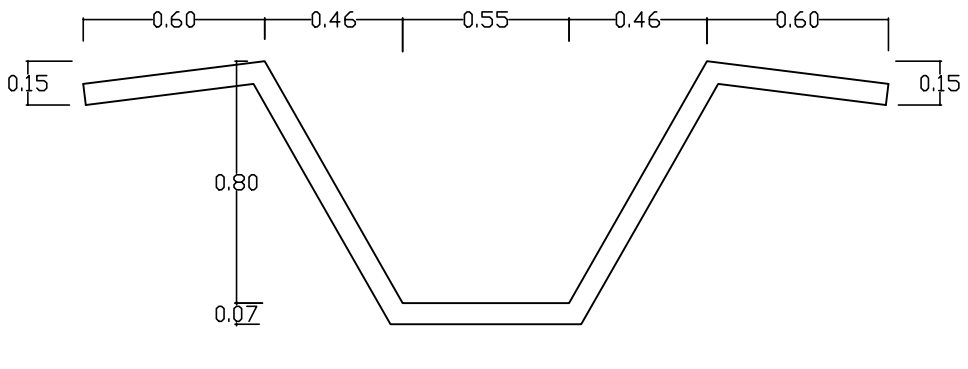

CANAL TRAMO 3
Esc. 1/25

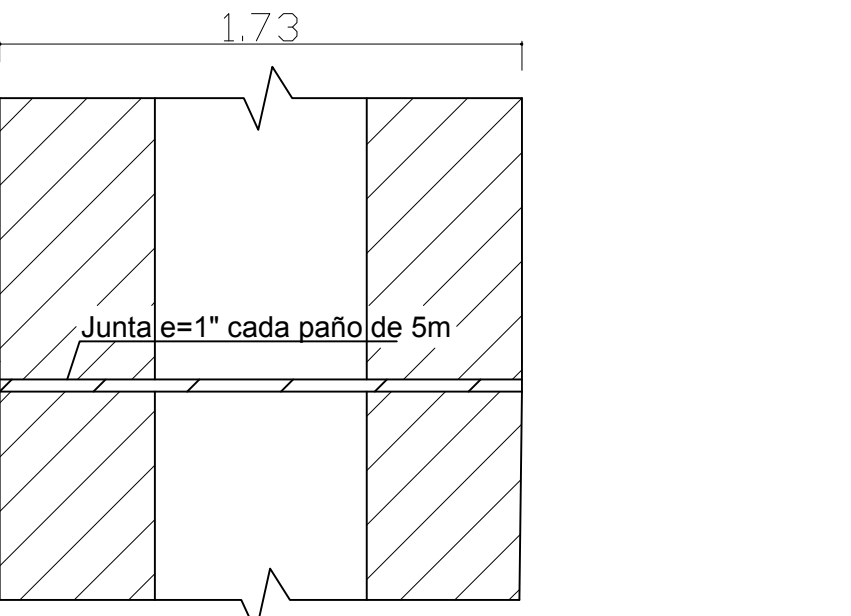

DETALLE PLANTA (JUNTA DE CANAL)
Esc. 1/25

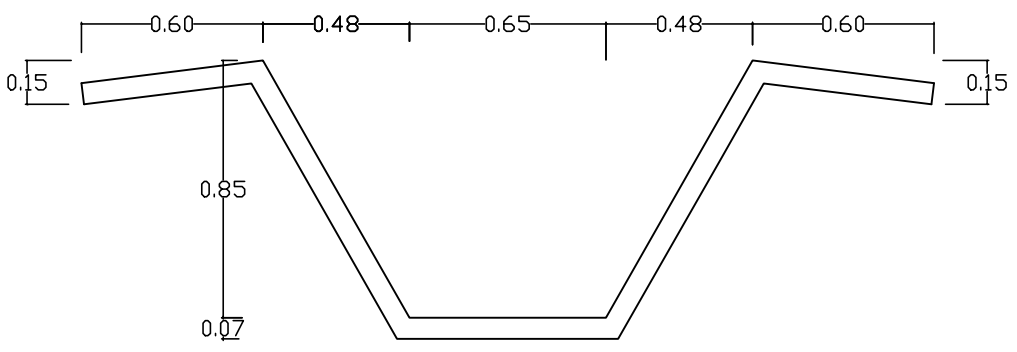

CANAL TRAMO 2
Esc. 1/25

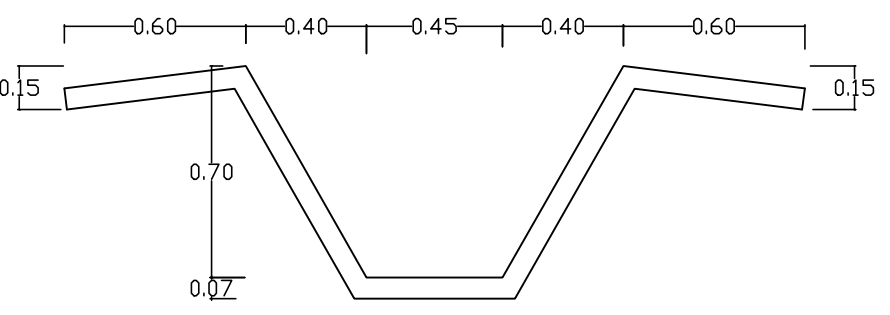

CANAL TRAMO 4
Esc. 1/25

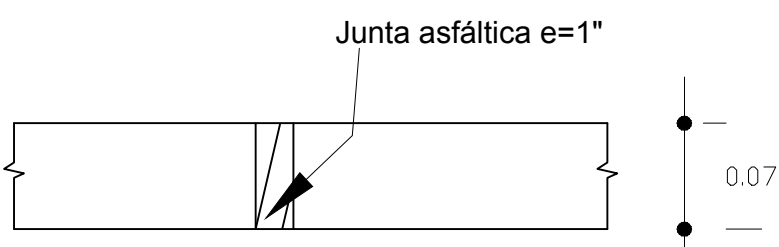

DETALLE JUNTA CANAL
Esc. 1/10

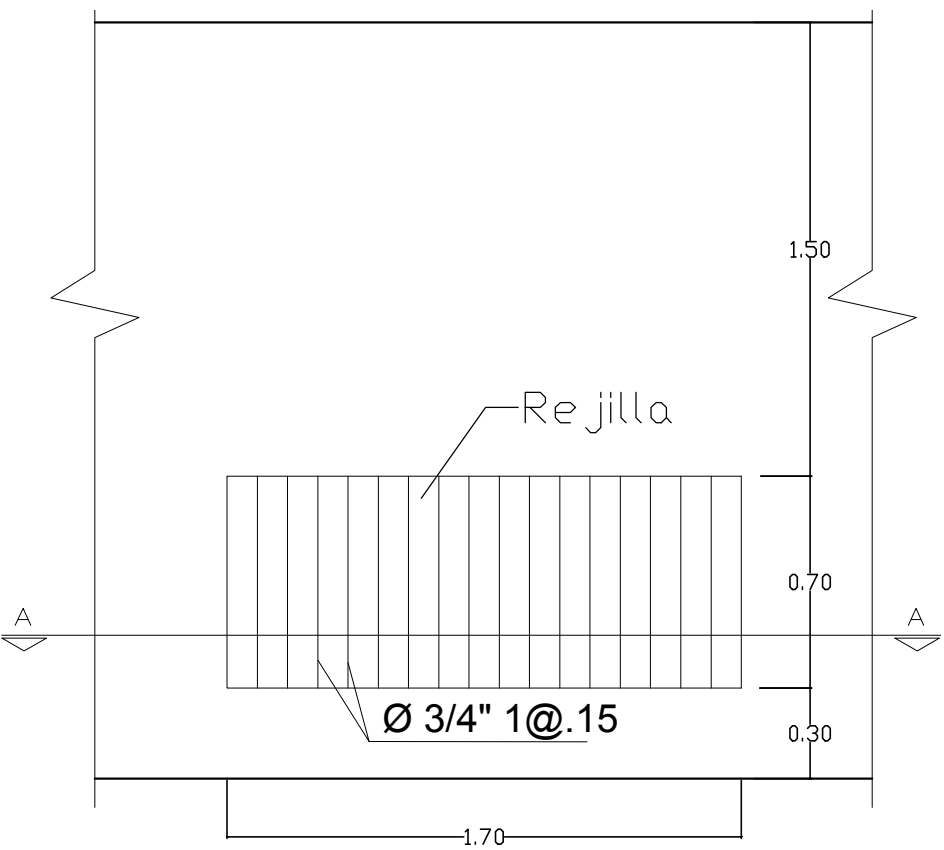

VENTANA DE CAPTACIÓN
Esc. 1/25

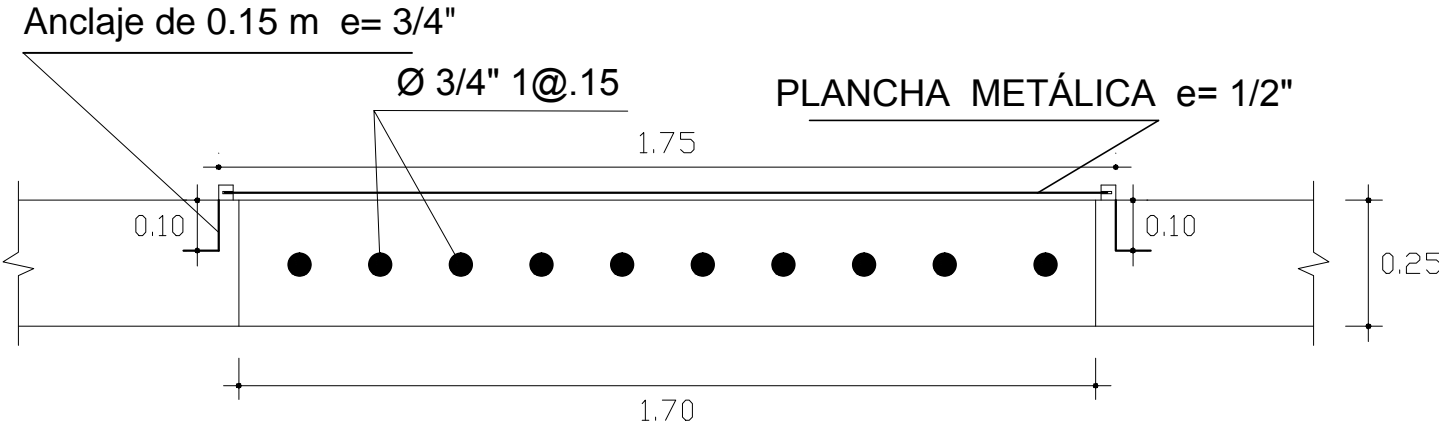

CORTE A-A VENTANA DE CAPTACIÓN
Esc. 1/15

 UNIVERSIDAD CATOLICA SANTO TORIBIO DE MOGROVEJO USAT - PERU		* DISEÑO DE LA BOCATOMA Y CANAL DE DERIVACIÓN DE PUEBLO ESCONDIDO, SECTOR MARRIPÓN, DISTRITO DE MOTUPE, PROVINCIA Y DEPARTAMENTO DE LAMBAYEQUE, 2017 *	
DISEÑADO		Ing. Eduardo Antonio Larrea Wong Mgtr. César Eduardo Cachay Lazo Mgtr. Wilmer Moises Zelada Zamora	
PLANO		DETALLES ARQUITECTURA	
RESPONSABLE		Jamber Julián Cabrera	
SECTOR	DISTRITO	PROVINCIA	REGION
MARRIPÓN	MOTUPE	LAMBAYEQUE	LAMBAYEQUE
DIS	ESC.	FECHA	INDICADA
		JUNIO 2018	